

NEXPOW

JUMP STARTER WITH AIR COMPRESSOR  
USER MANUAL



MODEL NO.: AKP-P200

Please read user manual before using,  
and keep it for further reference.

Product Description

- Please read this manual carefully and keep it properly before using this product for the first time. It will guide you to use it correctly and remind you of relevant precautions.
- The NEXPOW AKP-P200 4-in-1 product is jump starter, air compressor, LED flashlight, and portable power bank. The unit brings enough voltage and amperage right to the vehicle to bring a dead battery back to life. It has the function of inflating cars, motorcycles, bicycle tires and balls. It can be used as a mobile power source to charge smartphones, tablets, cameras, and other USB devices. And the model has LED light function.
- Note that this product is not a toy and children are forbidden to use it.

Product Features

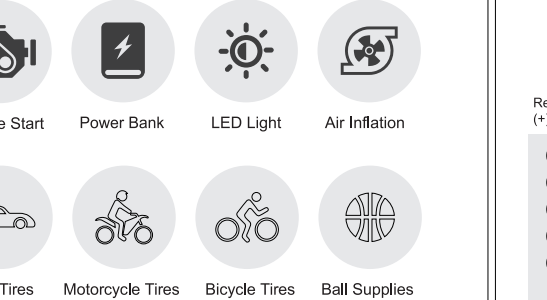

01

Product Diagram

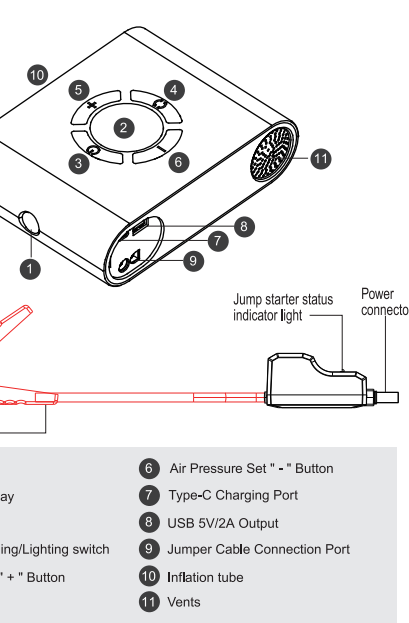

02

CHARGE DIGITAL PRODUCTS

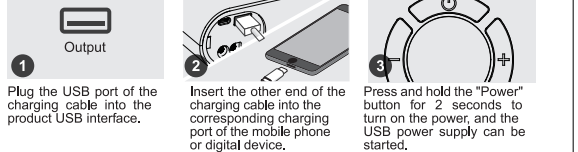

CAR JUMP STARTER OPERATING INSTRUCTIONS

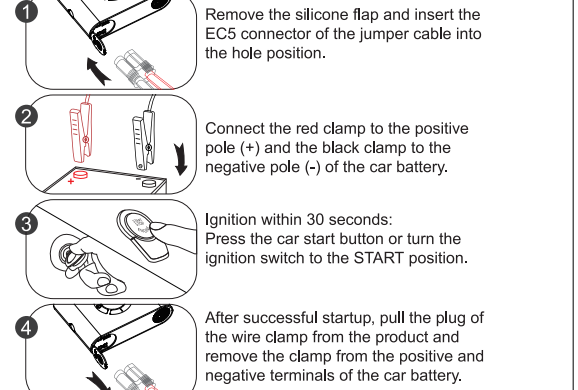

Note: When starting the car,  
please make sure that the power of the product is above 50%.

03

| Jumper Clamp Indicator Instruction |                      |   |
|------------------------------------|----------------------|---|
| Item                               | Technical parameters | Instruction   |
| Standby indication                 | support              | When the wire clamp is in standby mode, the red and green lights flash alternately.   |
| Work indication                    | support              | The wire clamp is in a conducting operational state and the green light is constantly on.   |
| High temperature protection        | support              | The wire clamp will automatically disconnect the output when the temperature exceeds 300°C±10°C, while the red light remains on and the buzzer continuously emits a rapid beeping sound. The protection will be automatically released when the temperature of the wire clamp drops below the protection threshold. |
| Reverse connection protection      | support              | When the wire clamp is connected in reverse to a car battery with a voltage higher than 1.0V, it triggers protection. The red light remains on, and the buzzer emits a continuous "beep, beep, beep" short sound. Protection is automatically released after troubleshooting.                                       |
| Relay adhesion alarm               | support              | After the relay on the line clamp sticks, an alarm will be triggered when powered on again, with a constant red light and the buzzer continuously emitting rapid short beeps. The protection will be automatically released after troubleshooting.  |
| Clip detachment inspection         | support              | If the red or black clamp of the wire clamp comes loose when starting the car, it will automatically return to standby mode after approximately 2.5 seconds.  |

04

| Jumper Clamp Indicator Instruction |                      |  |
|------------------------------------|----------------------|--|
| Item                               | Technical parameters | Instruction  |
| Input high voltage protection      | 17.5±0.5V            | When the wire clamp is in standby mode and the voltage at the ECS terminal exceeds this value, it triggers protection with the red light remaining on. Protection is automatically released after troubleshooting.   |
| Input low voltage protection       | 13.5±0.5V            | When the wire clamp is in standby mode and the voltage at the ECS terminal falls below this value, it triggers protection with the red light remaining on. Protection is automatically released after troubleshooting.   |
| Reverse charge protection          | support              | When protection is triggered, it automatically disconnects the output, and the red and green lights flash alternately. Protection is automatically released after troubleshooting.   |
| Start over limit protection        | support              | During the conduction process, if the wire clamp detects that the voltage at the starting port is too low, it will automatically disconnect the output. The red light will stay on, and the buzzer will emit one long and two short beeps. To release the protection, you need to power it up again. |
| Start timeout protection           | support              | If there is no ignition operation after correctly connecting to the car, the wire clamp will automatically disconnect the output after 60 seconds of conduction. The red and green lights will remain on, and you will need to power it up again to release the protection.                          |
| Short circuit protection           | support              | When the red/black clamps are short-circuited in standby mode without sparking or damage, triggering protection will result in the red light staying on and the buzzer emitting one long and two short beeps. Protection is automatically released after troubleshooting.                            |

05

Detailed Instructions For Inflation Function

1. Charge The Product (The adapter is not included)

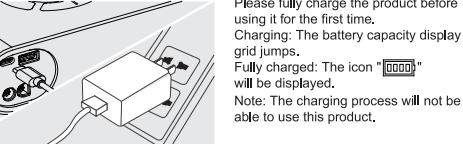

Please fully charge the product before using it for the first time.  
Charging: The battery capacity display grid jumps.  
Fully charged: The icon "100%" will be displayed.  
Note: The charging process will not be able to use this product.

2. Power On/Off

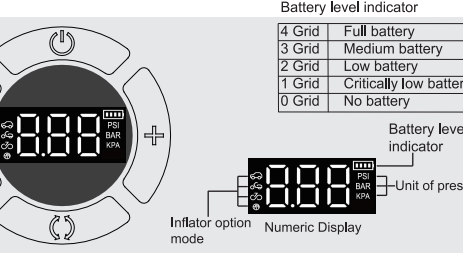

Battery level indicator  
4 Grid Full battery  
3 Grid Medium battery  
2 Grid Low battery  
1 Grid Critically low battery  
0 Grid No battery

Battery level indicator  
Unit of pressure  
Inflator option mode  
Numeric Display

06

3. Connect the Inflation Tube

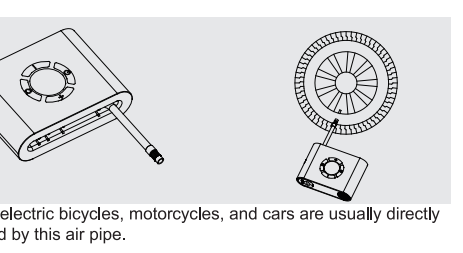

Bicycles, electric bicycles, motorcycles, and cars are usually directly connected by this air pipe.

07

4. Gas Nozzle / Gas Needle /Extension pipe  
Mounting Method

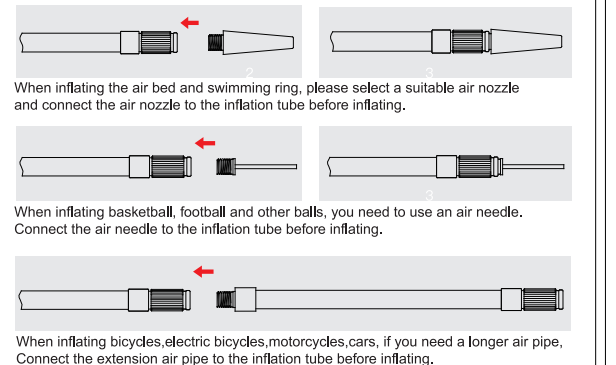

5. Inflation Air Pressure

To ensure safety, before using this device for inflation, please know the air pressure value required by the inflated item (check the surface information of the inflated item or query the instruction manual of the inflated item) to avoid personal injury caused by over-inflation.

08

Common Items Recommended Inflatable Air Pressure Gauge

| Category   | Types  | Recommended air pressure range               |
|------------|--|--|
| Car        | Car tires  | 2.2-2.8 Bar (32-40psi)                       |
| Motorcycle | Motorcycle, electric Motorcycle tires  | 1.8-3.0 Bar (26-44psi)                       |
| Bike       | Folding bicycle tires 12"14"16"bicycle tires<br>20"22"24"bicycle tires<br>26"27.5"29"bicycle tires | 45-50psi<br>30-50psi<br>40-50psi<br>45-65psi |
| Ball       | Basketball<br>Football<br>Volleyball<br>Rugby  | 7-9psi<br>8-16psi<br>4-5psi<br>12-14psi      |

Note:

- This product is not suitable for truck tires and road bicycle tires.
- The data of the recommended inflation air pressure range is for reference only. Please refer to the instruction manual of the inflated item for actual use. (The above data comes from the laboratory)

6. Preset Inflation Air Pressure Mode Selection

Short press the "P" button to select the inflation mode: each time you press this button, you can switch between the five inflation modes of "car", "motorcycle", "bicycle", "ball", and "custom mode". (Long press this key for 2 seconds to switch between PSI, BAR, KPA, three air pressure units.)

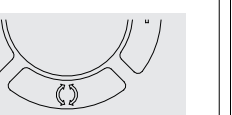

09

|  |   |
|--|---|
|  | Custom inflation mode: (There are no mode icons on the left side of the screen.) Default 35psi (approximately equal to 2.41bar) |
|  | Car inflation mode: Default 2.5bar (approximately equal to 36psi)   |
|  | Motorcycle inflation mode: Default 2.4bar (approximately equal to 35psi)  |
|  | Bicycle inflation mode: Default 45psi (approximately equal to 3.1bar)   |
|  | Ball inflation mode: Default 8psi (approximately equal to 0.55bar)  |

After select the matching inflation mode, the screen displays the default setting value and flashes three times at a frequency of once per second, and then enters the air pressure detection state to detect the current air pressure value of the inflated object. (When the inflated object is not connected, the air pressure value will display "0".)

Adjust Presets

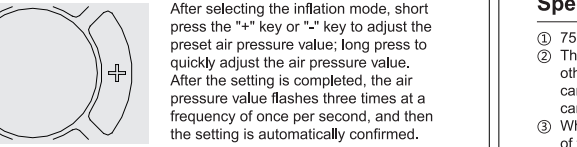

10

Caution:

- When adjusting the preset air pressure value, the number flashes to indicate the target air pressure adjustment status, and the number is always on to indicate the real-time air pressure.
- The default value will be restored after the mode is switched or restarted.
- When inflating the swimming ring and air bed, just adjust to "ball mode".

7. Inflation Instructions

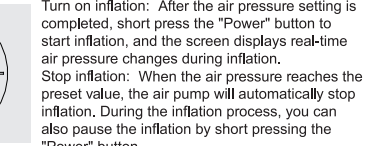

Shut down : In the power-on state, press and hold the "Power" button for 2 seconds to shut down. In order to avoid accidental touch, it will automatically shut down if there is no operation within 30 seconds when it is turned on.

Special Reminder

- 75-80dB noise will be generated during inflation.
- The inflation air pressure of balloons, toy balls, swimming rings and other products is less than the range of the air pump, and the inflation cannot be automatically stopped at the preset air pressure. Please be careful when using it.
- When the equipment continues to work for a long time, the temperature of the body and the gas tube will increase significantly. Please avoid touching the air tube with your hands for a long time. If the temperature is too high, please cool down before continuing to use it. Be careful of burns when disassembling the gas nozzle after use, there will be slight air leakage, please disassemble it quickly.
- Increased pressure load and lower ambient temperature may cause the endurance of this device to deteriorate.
- As the air pump generates a large amount of heat, please rest for at least 10 minutes after inflating for 10 minutes before using it.

11

8. LED Lighting

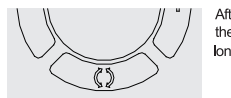

After the power is turned on, long press the "P" button for 4 seconds to turn on the lighting mode. Long press again in turn off the light.

Basic Parameters

|                           |   |
|---------------------------|---|
| Product Name              | Jump Starter with Air Compressor        |
| Model                     | AKP-P200                                |
| Size                      | 176 × 128 × 48mm                        |
| Adjustable Pressure Range | 3~150PSI/0.2~9.9BAR/20~990KPA           |
| Operating Temperature     | Charge : 0°C~45°C, Discharge ~20°C~60°C |
| Storage Temperature       | -10°C~50°C                              |
| Inflatable Tube Length    | 115mm(Including gas nozzle)             |
| Battery Capacity          | 29.6Wh                                  |
| Working Noise             | Less than 80dB away from 1 meter        |
| Charging Input            | Type-C 5V/2A                            |
| Charging Time             | About 4-5 hours                         |
| USB Output                | 5V/2A                                   |
| Start Car Voltage         | 12V                                     |

12

Precautions

Usage Notice

- This product is not a toy, and it is forbidden for children to use it; it is recommended for users over 16 years of age.
- When the product is used for the first time, charge the product for more than 3 hours.
- This product has a built-in non-removable lithium battery. It is forbidden to throw this product into a fire or throw it away at will. The lithium battery may catch fire, spontaneously ignite and explode due to overheating, impact or water. Please avoid exposure to the sun in the car, or exposed to high temperature environment.
- If the product is swollen, leaking or smells, please stop using it immediately.
- If the product has abnormal noise or high temperature during use, please stop using it and shut it down immediately.
- Please store or use in a dry and clean environment. Avoid dampness, heavy falls, water immersion and sand intrusion. The intrusion of sand and dust may cause damage to the product; this product is also not waterproof, and it is forbidden to wash in water.
- Please keep away from corrosive materials when storing this product, and the storage temperature should not be lower than -10°C or higher than 50°C. Too cold or too hot will shorten the life of the product and damage the built-in battery.
- Please keep this product charged at least once every 3 months.
- Do not disassemble the machine by yourself, otherwise it may cause a safety accident.

13

Inflation Notice

- The product has a built-in DC motor, which may generate electric sparks during operation. Please do not use it in an flammable and explosive environment.
- Before inflating, please confirm the required air pressure value of the inflated item to avoid personal injury caused by explosion caused by over-inflation.
- When setting the inflation air pressure value, please make sure that the measurement unit is selected correctly, otherwise it may cause accidents such as a tyre burst. Common unit conversion: 1bar=14.5psi, 1bar=100kPa.
- When inflating objects, please keep this product a safe distance from children.
- Do not bend or step on the inflation tube when inflating, and be sure to keep the airflow unobstructed.
- Operators are not allowed to leave the scene during inflation. Please observe the inflation process to prevent the inflation air pressure from being too high due to the unreset air pressure.

14

Packing List

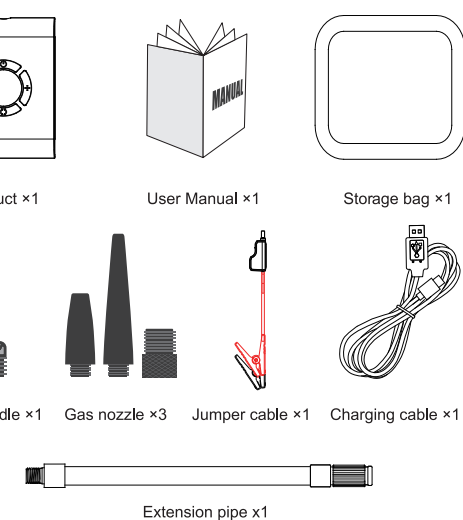

Note: The illustrations of products, accessories, and display interface in this manual are all schematic diagrams and are for reference only. Since the product is iteratively upgraded from time to time, the actual product and the schematic diagram may be different, please refer to the actual product!

15

Trouble Shooting

| Problem  | Elimination Method  |
|--|---|
| Slow inflation   | 1. Check whether the battery power is sufficient.<br>2. Check for air leaks in the trachea.<br>3. Check whether the connecting parts at both ends of the trachea are tightly installed.<br>4. Check whether the tires are flat. |
| Has been turned on, but cannot be inflated   | 1. Check whether the battery power is sufficient.<br>2. Check whether the air pressure of the inflated item is higher than the preset value.  |
| The inflation is normal, but the display pressure value is zero                      | Low-pressure inflated objects such as balloons are not within the measurable range of this device.  |
| After installing the gas nozzle tightly, the power has been automatically turned off | It will automatically shut down if there is no operation within 30 seconds, just restart it.  |
| There is air leakage when connecting the trachea                                     | Install the trachea tightly.  |

16

Air Pump Fault Code Display

| Code Display | Reason  | Solution                   |
|--------------|---|----------------------------|
| L0           | low voltage                                   | Charge the product         |
| ER2          | Motor overcurrent (average value)             | Contact our technical team |
| ER3          | Motor overcurrent (peak value)                | Contact our technical team |
| ER4          | motor overheating                             | Start after cooling down   |
| ER6          | Damaged sensor, open circuit or short circuit | Contact our technical team |

Your Warranty Includes

·12-Month Coverage  
Within 12 months of purchase, we will provide timely and effective online after-sales service. We will repair or replace any defective product (due to manufacturing fault) within the warranty period.

17