



LED DRIVING LIGHT / LIGHT BAR WIRING HARNESS QUICK GUIDE



SKU: LEDHARNESSHIGHBEAM

Wiring Diagrams

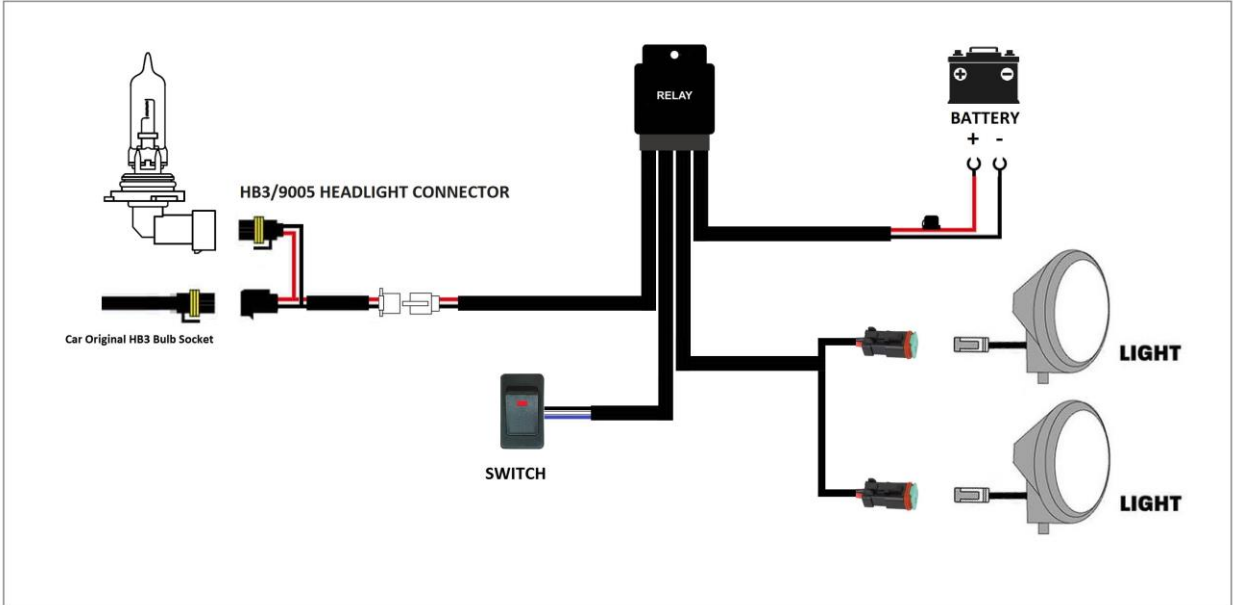

HB3/9005 Diagram

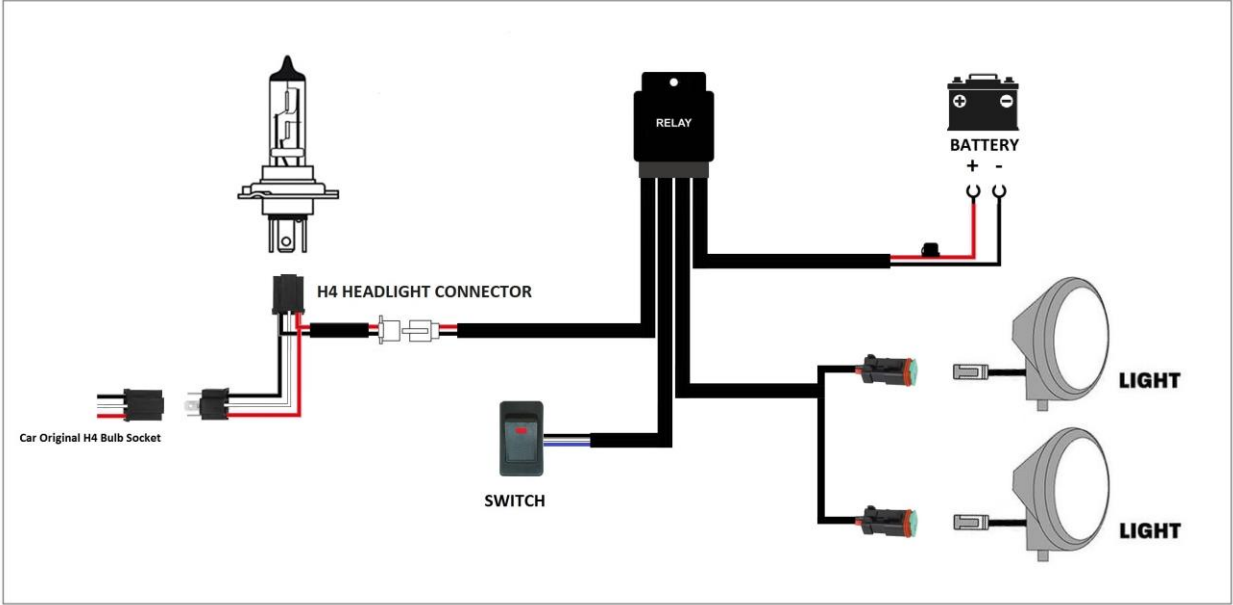

H4 Diagram

Installation

1. Lay out the wiring in the engine bay, making sure the DT plug can reach the location of your driving light or light bar, the terminals can reach the battery and the switch can penetrate through the firewall.
2. Remove the in-line fuse from the wiring harness.
3. Connect the negative (black) wire to the negative (-) battery terminal.
4. Find a suitable bolt to mount the relay and location which is safe from mud and water.
5. From the relay there will be a cord with a white plug on the end, this is to connect the driving light or light bar to your high-beam switch. Run this wire to the back of the headlight, disconnect the plug and place the HB3 or H4 piggy back adapter in-line. Connect the adapter to your light bar harness.
6. Next, run the DT plugs to the desired location where your driving lights is mounted.
7. Find a suitable place on the dash to mount the switch then disconnect the terminals and carefully run them through the vehicle's firewall into the cabin. Reconnect the terminals like so:



8. Connect the positive (Red) wire to positive (+) battery terminal and insert the in-line fuse back into its socket.
9. Check all of your connections, ensure the wires are kept away from any heat, sharp or moving parts.
10. Test the lights. Turn on the ignition and test light operation by switching on your high beam. Note: Driving Lights should activate when switched to high beam.

Negatively switched vehicles:

If the light bar does not come on or turns on with low beam, there is a good chance your vehicle is negatively switched. Here is how to adjust the adapter to work with a negatively switched vehicle

11. Remove the in-line fuse & disconnect the adapter from the back of the headlight.
12. Using a flat-head screw driver pop out the terminals from both the socket and the plug and reinsert them like so:

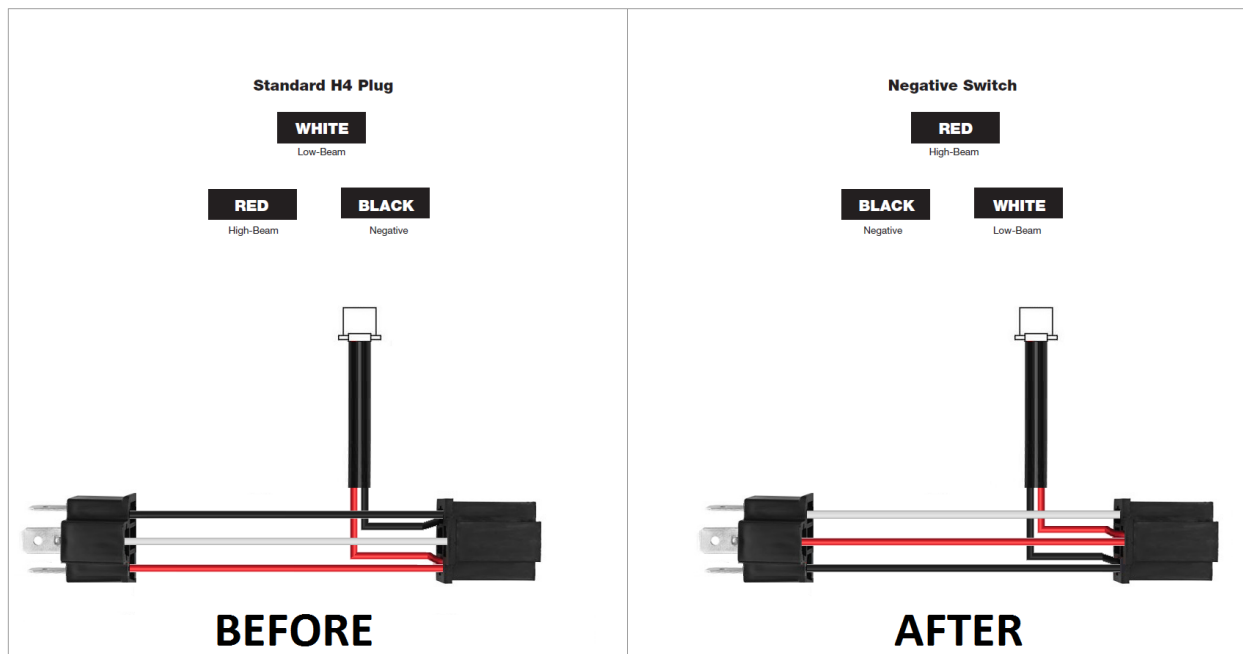

13. Insert the adapter back in-line with the headlight and connect to the wiring harness.
 14. Insert the in-line fuse back into the socket.
- Test the lights, they will now work with a negatively switched vehicle.

Warranty:

We provide 1 whole year of limited warranty for your product from the date of purchase to be free from defects in materials and craftsmanship. The warranty does not cover defects or malfunction caused by misuse, abuse or improper maintenance, failure to follow operating instruction and fair wear and tear.

For questions, support, or warranty claims feel free to contact us at 1300 881 773, send us an email at sales@elinz.com.au or chat with us